

ENGINE SERVICE TOOLS

Cam/Crankshaft Tools

Crank Bolt Socket Set 6 Piece

- SKU 919501 25276 **89⁹⁹**
- Set Includes: 17, 19, 21, 22, 26 and 27 mm
 - Heavy Duty Impact Grade Socket
 - Provides Increased Torque to Break Loose Stubborn Crank Bolt Sockets
 - Constructed with Durable Chrome Molybdenum
 - 1/2" Drive



Crank Bolt Sockets

- | | | |
|---|---|---|
| 17 mm
SKU 912348 25275 15⁹⁹ | 21 mm
SKU 912343 25273 15⁹⁹ | 26 mm
SKU 919500 25278 15⁹⁹ |
| 19 mm
SKU 919499 25274 15⁹⁹ | 22 mm
SKU 919496 25277 15⁹⁹ | 27 mm
SKU 919497 25279 15⁹⁹ |

5 Piece Master Cam Clamp™ Kit

- SKU 383452 27210 **59⁹⁹**
- Covers Most Single, Twin Cam and Quad Cam Engines
 - Locks Camshaft to Hold Valve Timing During Timing Belt Replacement



2 Piece Cam Clamp™ Set

- SKU 238159 24360 **24⁹⁹**



Timing Gear Holder

- SKU 544797 24387 **29⁹⁹**
- Holds the Timing Gear in Place During Removal and Installation and Prevents it from Moving While the Retaining Bolt is Removed
 - Allows the Cam Gear to Rotate to Align Valve Timing Marks
 - Single Lever Locking Design is Easy to Use



Honda Crankshaft Pulley Holding Tool

- SKU 217379 27176 **29⁹⁹**
- Holds Crankshaft Damper When Tightening/Loosening Crankshaft Bolt on Honda and Acura Engines 1990 to Present



Universal Camshaft Bearing Tool

- SKU 191677 27143 **179⁹⁹**
- Removes or Inserts Camshaft Bearings in Nearly All Engines
 - Easy on Bearings
 - Range: 1.125" to 2.69"
 - Set Includes: Driving Shaft, Driving Shaft Extension, Expander Unit, (5) Split Driving Plugs, (2) Driving Collars and Centering Cone

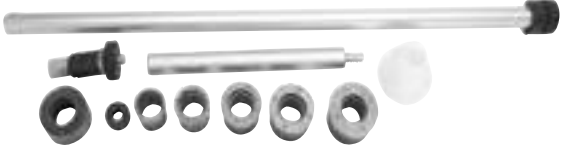

Camshaft and Crankshaft Seal Tool Kit

- SKU 544799 24386 **99⁹⁹**
- Easily Removes and Installs Camshaft and Crankshaft Seals
 - Compact Puller with Unique Extracting Hooks Engage Seal for Quick Removal
 - Interchangeable Sleeves and Mandrels Allow Easy Installation of New Seal
 - Suits Seals from 21.5 mm - 64 mm
 - Sleeves and Mandrels Made from High Strength Fiber Glass Reinforced Polymer



Ford Cam Phaser Noise Repair Kit 4.6/5.4 3V

- SKU 494959 LMEF1503V **699⁹⁹**
- Prevents and Corrects Common Failure Point in 2004-2014 4.6 and 5.4 3V V8 Ford Vehicles
 - Eliminates Cam Phaser Knock
 - Simple in Design and Requires No Special Tools to Install
 - Included Wedge Tool Simplifies Phaser Removal and Securely Holds Chains in Position Simple to Operate Tuner with OBD-II Cable Included
 - *CARB E.O. Pending*



Application List	
2005-2010 Mustang 4.6	2005-2010 F250/350 5.4
2006-2010 Explorer/Mountaineer 4.6	2007-2010 Explorer Sport Trac 4.6
2004-2010 F150 5.4	2005-2014 Expedition (including EL)/Navigator 5.4
2009-2010 F150 4.6 3v	

Ford 2.0L, 2.3L, 2.5L Cam Tool Kit

- SKU 626108 24448 **17⁹⁹**
- Applications: 2.0L DOHC Engines Found in 1994-2003 Ford and Mercury, 2004-2012 2.5L DOHC, 2.3L DOHC 4V and 2.0L DOHC Engines in Ford, Mercury and Mazda, and 2.0L DOHC Engines in 1993-1994 Ford Probe



Universal Pulley and Fan Clutch Holder

- SKU 547013 27281 **54⁹⁹**
- Fits Many Different Fan Clutches, Cam and Crank Pulleys with Slots or Holes
 - Adjustable Diameter: 1-1/2" - 8-5/8"
 - Pin Sizes: 6-10 mm, 8-11 mm, 10-12 mm, 11-16 mm

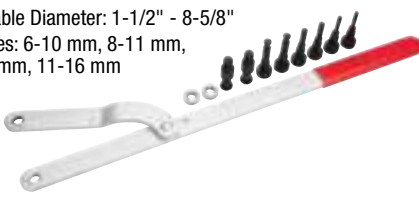

DOHC Cam Lock Holder

- SKU 291419 LIS36880 **39⁹⁹**
- This Versatile Tool Easily Locks and Holds Both Camshaft Sprockets Firmly in Place
 - Preserves the Engine Timing During Belt or Chain Replacement



Universal Cam Adjuster

- SKU 222524 LIS38220 **39⁹⁹**
- Adjusts to Fit Different Size Cam Sprockets
 - Holds Cam Sprocket in Place When Removing Cam Bolt
 - Works on All Single and Dual Overhead Cam Sprockets with Holes



Belt Service Tools

Serpentine Belt Tool

- SKU 013620 24687 **19⁹⁹**
- Provides Leverage and Clearance to Release the Spring Pressure and Remove the Tensioner Pulley
 - Includes 4 Shallow Sockets, Sizes: 13, 15, 16 and 18 mm; and 1/2" and 3/8" Square Drive Adapters



Serpentine Belt Tool

- SKU 695121 33627115 **24⁹⁹**
- Provides Required Leverage and Clearance to Release Spring Pressure and Remove Tensioner Pulley



Stretch Belt Remover and Installer

- SKU 255866 LIS59370 **22⁹⁹**
- Unique Magnetic Faces Hold the Tool in Place on the Pulley
 - Compact, One-Piece Tool Can Be Used on the Front or Back Side of the Pulley



"Easy On" Stretch Belt Installation Tool

- SKU 227303 24362 **13⁹⁹**
- Allows Stretch Belts to Be Quickly Installed without Damage
 - Accommodates Larger Pulleys Found on Many Vehicles' Serpentine Belt without the Belt Slipping Out of the Tool



Stretch Belt Installation Tool

- SKU 227301 24363 **21⁹⁹**
- Works on Both Large and Small Pulleys
 - Clamping Jaw Allows User to Position Serpentine Belt without the Belt Slipping Out of the Tool



Stretch Belt Mate Kit

- SKU 544729 24388 **5⁹⁹**
- Easily Installs All Stretch Fit Belts



Belt Holding Tool

- SKU 087299 OTC7424 **26⁹⁹**
- Keeps Belt from Falling Off of a Pulley During Belt Installation
 - Universal Design to Fit Most Pulley Styles and Sizes
 - Super Strong Magnet to Hold the Belt Firmly on the Pulley



Fan Clutch Tools

BMW Cooling Fan Wrench Set

- SKU 912340 25100 **19⁹⁹**
- One Tool Holds the Water Pump Pulley in Place, While the 32mm Ultra-Slim Specialty Wrench is Used to Loosen the Radiator Fan Nut
 - 32mm Wrench Features Dipped Rubber Handle for Improved Grip
 - Water Pump Pulley Holder is Outfitted with Multiple Holding Points to Fit a Variety of BMW Vehicles



Ford 4.9 L Fan Clutch Wrench Set

- SKU 002043 27018 **19⁹⁹**
- Services Thermostatic Fan Clutch Assemblies on Ford Vans, Trucks, Light Trucks, and SUVs
 - Set Includes: 1-7/16" (36 mm) and 2-1/4" (57 mm) Wrench Sizes
 - Wrench Length: 14"



Fan Clutch Wrench Set

- SKU 110280 27186 **59⁹⁹**
- Combines OEMTOOLS™ #27108 and OEMTOOLS™ #27141 Into a Master Set
 - Ideal for Removing Fan Clutches from Water Pumps
 - Set Includes: 36, 40, 48, 54, 57, 68, 72, 76 and 83 mm Wrench Sizes



Fan Clutch Service Set for Mercedes-Benz and BMW

- SKU 512958 27224 **129⁹⁹**
- Removes Lock Nuts on Thermo Viscous Fans Found on Mercedes-Benz, BMW and Many Ford Models
 - Includes:
 - (1) Mercedes-Benz Fan Clutch Wrench - 36 mm, 40 mm and 65 mm Opening
 - (1) BMW Fan Clutch Wrench - 32 mm Opening
 - (1) BMW Fan Clutch Holding Wrench - 38 mm and 44.5 mm
 - (1) Mercedes-Benz Fan Clutch Holding Tool

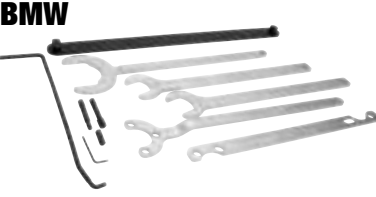

Fan Clutch Holding Tool-GM, Ford, Dodge

- SKU 409637 27270 **80⁹⁹**
- Aids in Changing Fan Clutch by Holding the Pulley
 - Fits Many GM, Ford and Dodge Vehicles



Pneumatic Fan Clutch Wrench Set

- SKU 291409 LIS43300 **179⁹⁹**
- Quickly Removes and Installs Fan Clutch When Repairing the Water Pump or Fan Clutch
 - Set Includes Wrench Sizes: 32, 36, 40 mm; 7/8", 1-7/8" and 2"

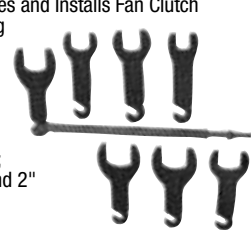

Fuel System Cleaner

MOTORVA

Carbon Clean 1000

- SKU 305905 MVC500-0220 **1,309⁹⁹**

- Complete, Through the Rail, Fuel System Decarbonizing Service
- Fuel Rail Hookup Provides the Most Effective Results
- Online Application Guide
- Unique Time Saving Adapter System
- Cleans Fuel Injectors, Combustion Chamber and Intake Valves
- Utilizes the MV5 Proprietary Fuel System Cleaning Chemistry



DID YOU KNOW?

AutoZone® has instrument clusters available.

Contact Your AutoZone Commercial Sales Manager for Details

877-AZTool1
877-298-6651
Hablamos Español
AZtool1.com

Valve Tools

Valve Spring Compressor for 3-Valve Engines

- SKU 814391 24429 **59⁹⁹**
- Designed to Compress the Valve Spring without Removing the Camshaft While Servicing the Cylinder Head in Ford 3-Valve Engines
 - For Use with Ford 3-Valve 4.6L and 5.4L Engines

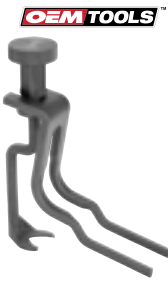

Ford Valve Spring Compressor

- SKU 626111 24434 **49⁹⁹**
- Applications: 1991-2004 Ford Vehicles with 4.6L, 2V, V8 Engines; 4.6 4V, 5.4 V8 and 6.8 V10
 - Works with Engine Removed or Installed, Cylinder Head On or Off
 - Not for Triton 5.4 3V



Valve Spring Compressor

- SKU 552331 25064 **4⁹⁹**
- Works on GM V8 Engines
 - No Need to Remove Cylinder Heads



Valve Spring Compressor

- SKU 231210 25220 **19⁹⁹**
- Designed for Use on Most Trucks and Cars with Overhead Valves



STORE STOCKED

Hydraulic Valve Lifter Puller

- SKU 695103 33627146 **17⁹⁹**
- Use for Removing Many Valve Lifters from Engine Block



Valve Keeper Remover and Installer Kit

- SKU 011658 LIS36050 **79⁹⁹**
- Makes Valve Component Disassembly and Reassembly Fast and Easy
- For Use with Valve Stems from 4.5 to 7.5 mm and 5/16" to 3/8"
 - Magnet in Tool Body Captures Keepers
 - Works on Toyota 4 Cylinder and Chrysler New World Engine



Push Rod Remover

- SKU 459100 LIS48300 **21⁹⁹**
- Redesigned for Newer 3.5L and 3.6L GM Engines - Also Works on GM V6 2.8L, 3.1L and 3.4L
 - Quickly Removes Push Rods to Replace the Intake Gaskets without Removing Rocker Arms



Piston Tools

Piston Ring Compressor

- Designed with Double Friction Brake Adjustment and Hardened Tool Ratchet
- Constructed of High Grade Spring Steel with 1/4" Square Drive Adjuster
- Beaded Edge Prevents Tool from Entering Cylinder with Pistons



3-1/2"-7"

SKU 531947 25039 **8⁹⁹**

2-1/8" - 5"

SKU 531921 25037 **8⁹⁹**

Piston Ring Compressor

- SKU 013641 24682 **14⁹⁹**
- 1-1/2" Deep, Low-Friction Wrinkle Band
 - Fits 3" to 5" Pistons



STORE STOCKED

Piston Ring Expander Pliers

- SKU 003509 25083 **17⁹⁹**
- Eliminates Piston Ring Damage and Distortion During the Installation and Removal Process
 - Dipped Rubber Handles for Improved Grip
 - Diameter Range: 3-1/8" (80 mm) to 4-5/8" (120 mm)



Piston Groove Cleaner

- SKU 695604 33627038 **15⁹⁹**
- The Blades are Set in the Wheel Which May Be Rotated to Bring the Desired Blade into Position



Head Bolt Tools

Torque Adaptor, Diesel Head Bolt, Ford 6.0L Power Stroke® Engines

- SKU 298191 24208 **16⁹⁹**
- Prevents Damage to the Rear Heat Shield
 - Use with OEMTOOLS™ 27309 3/4" Drive Torque Wrench and OEMTOOLS™ 22398 18 mm Socket
 - Eliminates the Need to Remove the Evaporator Housing, Saving Time A/C Recharging
 - Eliminates the Need to Remove the Truck/Van Cab to Access the Rear Head Bolts



Flywheel Tools

Duramax Flywheel Lock

- SKU 301613 LIS22100 **49⁹⁹**
- Locks Flywheel in Place When Removing Harmonic Balancer on 6.6L Duramax with Allison Transmissions
 - Saves Time By Locking the Flywheel at the Transmission Instead of Having to Remove the Starter for Water Pump Replacement



Flywheel Turner

- SKU 505066 LIS23800 **36⁹⁹**
- For Turning and Holding Flexplates and Flywheels
 - Easily Turn Engine from Underneath the Vehicle



Spark Plug Sockets

3/8 Drive Magnetic Spark Plug Socket Set- 3pc

- SKU 300140 22891 **19⁹⁹**
- Includes: 5/8", 9/16", and 13/16" Pump Replacement



SPARK PLUG SOCKETS					
Part #	SKU	Drive	Size	Features	Price
22880	082923	3/8"	9/16"	Magnetic	\$5.99
22881	082929	3/8"	18 MM	Magnetic	\$5.99
22882	082931	3/8"	3/4"	Magnetic	\$5.99
22883	082932	3/8"	13/16"	Magnetic	\$5.99
22885	300146	3/8"	5/8"	Magnetic	\$14.99
22886	300147	3/8"	9/16"	6" Extension	\$14.99
22887	825933	3/8"	5/8"	Magnetic	\$5.99
22889	825934	1/2"	13/16"	Magnetic	\$5.99
22895	082936	3/8"	14 MM	Extra Thin Wall	\$5.99

3/8" Drive 14 mm x 12 pt. Spark Plug Socket

- SKU 814164 22814 **9⁹⁹**
- Designed with a Universal Joint for the Installation and Removal of Spark Plugs Situated in Tight Spaces
 - Durable Chrome Moly Steel Construction



3/8" Drive 14 mm x 12 pt. Spark Plug Socket - 1' Extension

- SKU 814337 22813 **12⁹⁹**

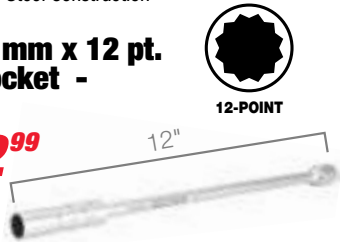

Spark Plug Boot Pliers

- SKU 390900 25542 **9⁹⁹**
- Designed to Remove Hard to Reach Spark Plug Boots
 - Do Not Use When the Engine is Running



STORE STOCKED

Adjustable Spark Plug Wire Puller

- SKU OUTSIDE BUY/EPO LIS51750 **19⁹⁹**
- Adjustable Plier Jaw for Easier Access
 - Cushioned Jaws Grip Straight-On or at an Angle



Available via Outside Buy/EPO, Call 1-877-298-6651 for Ordering Instructions

Spark Plug Wire Puller

- SKU 532549 25061 **3⁹⁹**
- Insulates Hands From Electric Shock. Grips Directly on Boot to Prevent Wire Damage.



STORE STOCKED

Engine Cylinder Hones

Flex-Hone™ BC and Flex-Hone™ GB

180 Grit Silicon Carbide with 8" OAL

BC 180SC Flex-Hone Tool Kit

- SKU OUTSIDE BUY/EPO BRM14353 **169⁹⁹**
- 10 Piece Kit Features Flex-Hone Sizes: 10 mm, 1/2", 5/8", 3/4", 7/8", 1", 1-1/4", 1-1/2", 1-3/4" and 2"
 - Complimentary Snap Back Hat, 1/2 Pint of Flex-Hone Oil, and 1GB Flash Drive

Available via Outside Buy/EPO, Call 1-877-298-6651 for Ordering Instructions



Product	Cylinder Diameter		Part #	SKU	Price
	Metric	SAE			
FLEX-HONE™ BC	8 MM	.394"	BRMBC10M18	341249	\$13.99
FLEX-HONE™ BC	10 MM	.250"	BRMBC64M24	343384	\$12.99
FLEX-HONE™ GB	83 MM	3-1/4"	BRMGB31412	341232	\$37.99
FLEX-HONE™ GB	89 MM	3-1/2"	BRMGB31212	341239	\$44.99
FLEX-HONE™ GB	95 MM	3-3/4"	BRMGB33412	341317	\$44.99
FLEX-HONE™ GB	105 MM	4-1/8"	BRMGB41812	341325	\$44.99
FLEX-HONE™ GB	118 MM	4-5/8"	BRMGB45812	341332	\$49.99

ADDITIONAL SIZES AVAILABLE - CALL US AT 1-877-298-6651 OR VISIT AZTOOL1.COM

Adjustable Engine Cylinder Hone Deglazer

- SKU 532002 25041 **31⁹⁹**
- Range: 2" to 7" (51 mm to 128 mm)
 - Spring Tension Adjusting Nut for Positive Cutting Action at All Speeds
 - Supplied with 4" Medium Grit Stones

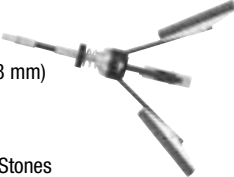

STORE STOCKED

Replacement Stone Sets

- SKU 141540 2541C **11⁹⁹** SKU 532036 2541M **11⁹⁹**
- 3 Coarse Grit (#100)
 - 3 Medium Grit (#220)
- SKU 532044 2541F **9⁹⁹**
- 3 Fine Grit (#400)

STORE STOCKED

Throttle Depressors

Brake - Accelerator Pedal Depressor

- SKU 802194 24232 **29⁹⁹**
- Extends to 24"
 - Suitable for Many Diagnostic Applications

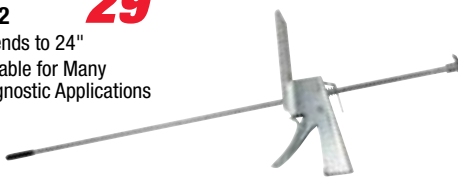

Throttle Pedal Depressor

- SKU 222525 LIS48700 **31⁹⁹**
- Holds Throttle at a Constant RPM
 - Length: 40"

